



## DENTAL CABINETS OWNERS MANUAL

**BOW WOOD CABINET SYSTEMS**

**1.888.BOW.WOOD (269.9663)**  
Monday to Friday 8:00AM to 4:00PM (Central Time)

Fax: 306-483-2102

E-mail: [design@bowwood.net](mailto:design@bowwood.net)

Table of Content

CARE & MAINTENANCE ..... 4

Corian® Countertops

Laminate Countertops and Fronts

Cabinet Interiors

EQUIPMENT .....5

Foot and Knee Activated Faucets

ADJUSTMENTS ..... 5

Hinges & Shelf Pins

Drawer Touch Latch & Cabinet Levelers

CORD MANAGEMENT ..... 8

Rear Support

Centre Island

Sterilization Centre Cord Management

ASSEMBLY / DISASSEMBLY ..... 9

Rear Support Disassembly

Centre Island Assembly

RS PEX Assembly

Sterilization Centre Assembly

INSTALLATION ..... 14

Steel Base Installation

Pass through X-ray Installation

SATISFACTION SURVEY ..... 17

5 YEAR WARRANTY

**Guaranteed to be free from defects** in workmanship and materials for five years from the date of purchase. Warranty covers the replacement of defective parts or components only (labour not included). Warranty does not cover damage by misuse, improper installation or accident. Warranty does not cover damage or discoloration caused by cleaning or disinfecting processes and chemicals. Freight damage is the responsibility of the freight carrier.

CARE AND MAINTENANCE

CABINET INTERIORS:

- ◆ Once again in most cases cabinet interiors can be cleaned using a damp nonabrasive cotton cloth and a mild liquid detergent or household cleaner. Rinse with clean water, using a clean, nonabrasive cotton cloth. Do not flood material, especially near seams, since water will penetrate and may cause the melamine to swell. Dry with a soft, clean, nonabrasive cloth.
- ◆ Do not use abrasive cleaners or materials to clean surfaces.

CORIAN® COUNTERTOPS:

- ◆ Routine daily cleaning can simply be done with soapy water or ammonia-based cleaners. These will remove most dirt and stains from all types of Corian finishes.
- ◆ Do not use alcohol based surface disinfectants.
- ◆ Avoid exposing Corian® to strong chemicals. If contact occurs, quickly flush the surface with water.
- ◆ Although Corian® is quite resistant to heat, always use a hot pad or other insulating device to reduce risk of damage.
- ◆ Minor damage such as, nicks, scratches, stains or burns can be repaired with a light abrasive cleaner and a product such as a Scotch-Brite® pad (very fine).
- ◆ If damage is more significant, please contact Bow Wood or the dealer from which you purchased your cabinets for further instruction.

QUARTZ COUNTERTOPS:

Quartz does not need to be sealed and cleaning is a cinch. Wipe the surface with soap and water on a regular basis to maintain its beauty and shine for years to come.

- ◆ **Difficult Spills** - soak the area for 10 minutes with a mild household cleaner (such as Formula 409®, Lysol®, or Windex®) then rinse and clean away with a soft Scotch Brite® pad. For stains that harden as they dry, such as food and gum, remove by gently scraping off of the surface (using a blade or putty remover) and then clean using warm water and soap.
- ◆ **Extreme Heat** - Quartz is resistant to heat and can withstand moderately high temperatures for brief periods of time without being damaged. As with any natural stone, however, certain exposure to heat may cause cracks due to thermal shock. Always use a rivet to place hot items. Do not use crock pots or electric skillets while in direct contact with natural quartz surfaces.
- ◆ **Harsh Chemicals** - The following may harm Quartz: Drano®, Liquid Plumr®, oven cleaners and floor strippers. DO NOT use these or any other harsh chemicals on your Quartz surface.
- ◆ **Sunlight Exposure** - Continuous long-term exposure to direct sunlight (UV rays) may result in slight discoloration of Quartz surfaces.
- ◆ **General Precautions** - To prolong the life of your knives, always use a cutting board. Natural quartz is one of the hardest minerals found in nature, making it highly scratch resistant. That same hardness may dull the sharpness of most knives.

## CARE AND MAINTENANCE

### LAMINATE COUNTERTOPS AND FRONTS:

- ◆ In most cases laminate counters can be cleaned using a damp nonabrasive cotton cloth and a mild liquid detergent or household cleaner. Rinse with clean water, using a clean, nonabrasive cotton cloth. Do not flood the laminate, especially near seams, since water can penetrate and cause the core to swell. Dry with a soft, clean, nonabrasive cloth.
- ◆ Do not use abrasive cleaners or materials to clean surfaces.
- ◆ Knives or other sharp instruments can slice or scratch the laminate surface, so always use care when using these items.
- ◆ Ceramics and abrasive objects can cause scratching and premature wear, so avoid sliding these items across the surface.
- ◆ For difficult stains or if substantial damage occurs please contact Bow Wood, or the dealer from which you purchased your cabinets.

## EQUIPMENT

### FOOT AND KNEE ACTIVATED FAUCETS

Dental cabinets with sinks can be equipped with an optional foot or knee activated faucet. If your cabinet has this option, please read the operating instructions below.

- ◆ To operate the “Tapmaster” faucet press the foot or knee lightly against the vertical face of the kick pedal and open the faucet to the desired flow and temperature. By releasing the pedal, the “Tapmaster” shuts off the water flow to the faucet. Once the faucet has been adjusted it may be left open. For continuous operation, press down in the middle of the top angled face until the pedal latches. This will provide continuous flow to the faucet until such time as the vertical face is tapped again to unlatch the pedal.
- ◆ A removable decal is provided which may be located on any hard smooth surface near the faucet to alert people to its method of operation.

## ADJUSTMENTS

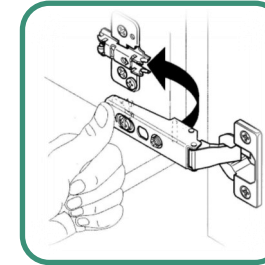

**TO ATTACH DOORS**  
align the pin in the hinge to the front slot in the hinge plate and snap the back of the hinge into place. You should hear a distinct “clip” sound signifying that the hinge is in place.

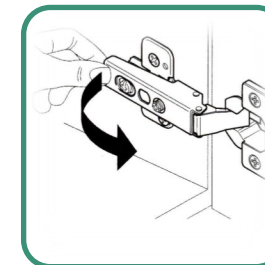

**TO REMOVE DOORS**  
simply pinch the clip at the back of the hinge and pull away from the cabinet.

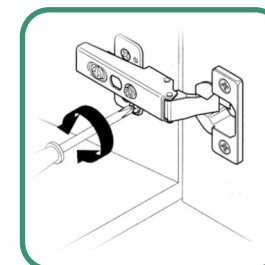

**FOR HEIGHT ADJUSTMENT**  
simply turn the height adjustment screw clockwise or counter clockwise to raise or lower the door to it's desired height.

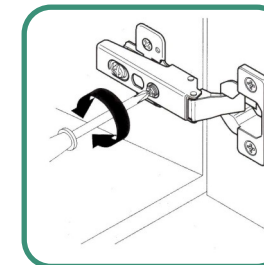

**FOR SIDE ADJUSTMENT**  
turn front adjustment screw clockwise or counterclockwise until you reach the desired location.

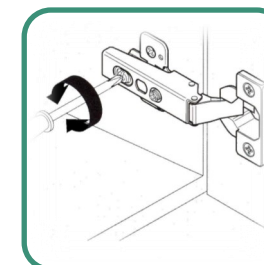

**FOR DEPTH ADJUSTMENT**  
turn the back adjustment screw clockwise or counterclockwise until you reach the desired location.

## ADJUSTMENTS

### SHELF PIN ADJUSTMENT

Simply pull the shelf pin out of its existing hole and relocate it to the new position. If the pin is difficult to remove, just use a pair of pliers or some other gripping device and twist it out. If the pin is resistant to go into the new hole, simply tap it in with a small hammer.

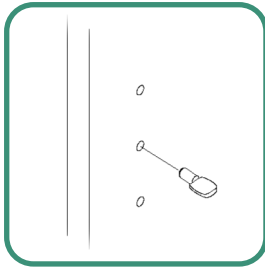

### DRAWER TOUCH LATCH

Bow Wood's drawer touch latch can be adjusted in one simple procedure. Remove the drawer and turn the barrel either clockwise, which will pull the drawer in, or counter-clockwise, which will push the drawer out.

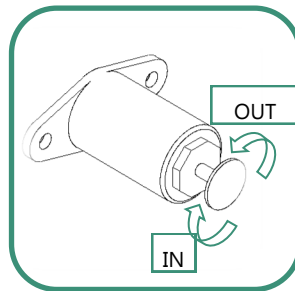

### EQUIPMENT GARAGE LEVELERS

Bow Wood's Cabinet Levelers can be adjusted in one simple step. Simply apply the proper sized wrench or a properly adjusted crescent wrench to the hex shape near the bottom of the leveler. Turn the desired levelers in either direction until your cabinet is level.

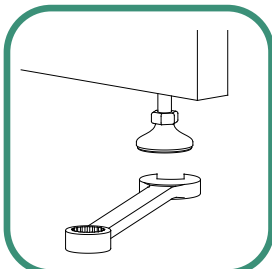

### STEEL BASE LEVELERS

Just like our garage levelers, simply apply the proper sized wrench to the hex shape near the bottom of the leveler, or a screwdriver to the top of the leveler. Turn the desired levelers in either direction until your cabinet is level. Levelers can be accessed through the opening in the bottom of the base cabinet through the opening in the bottom of the base cabinets.

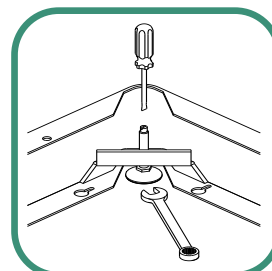

## CORD MANAGEMENT

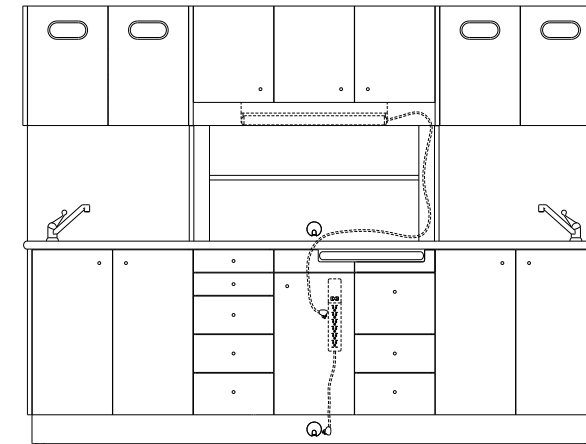

REAR SUPPORT

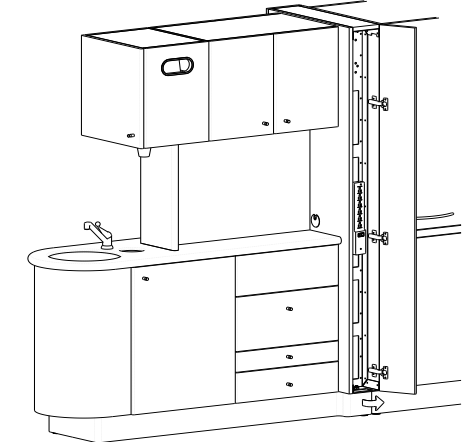
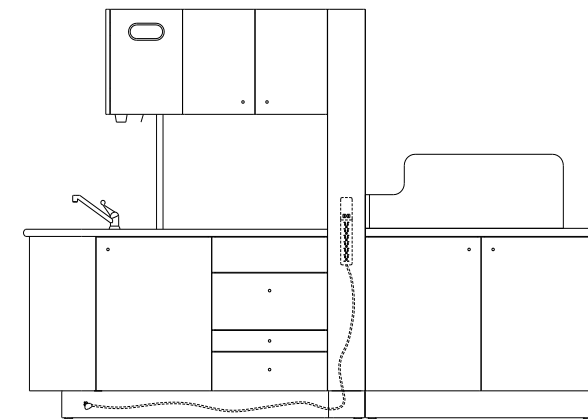

CENTRE ISLAND

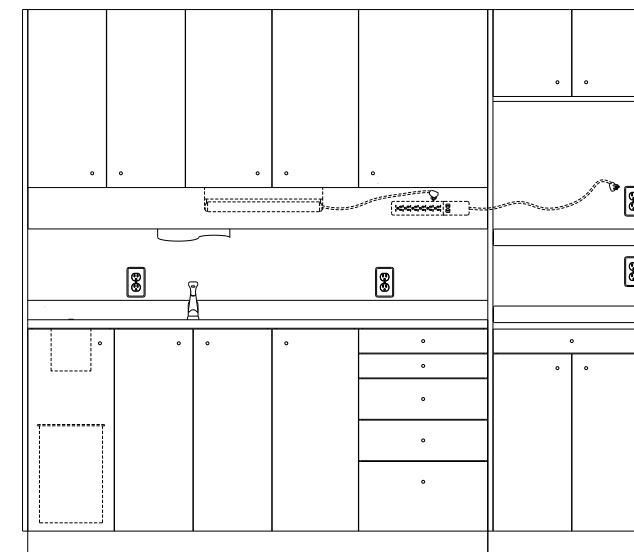

STERILIZATION CENTRE

## ASSEMBLY / DISASSEMBLY

### REAR SUPPORT

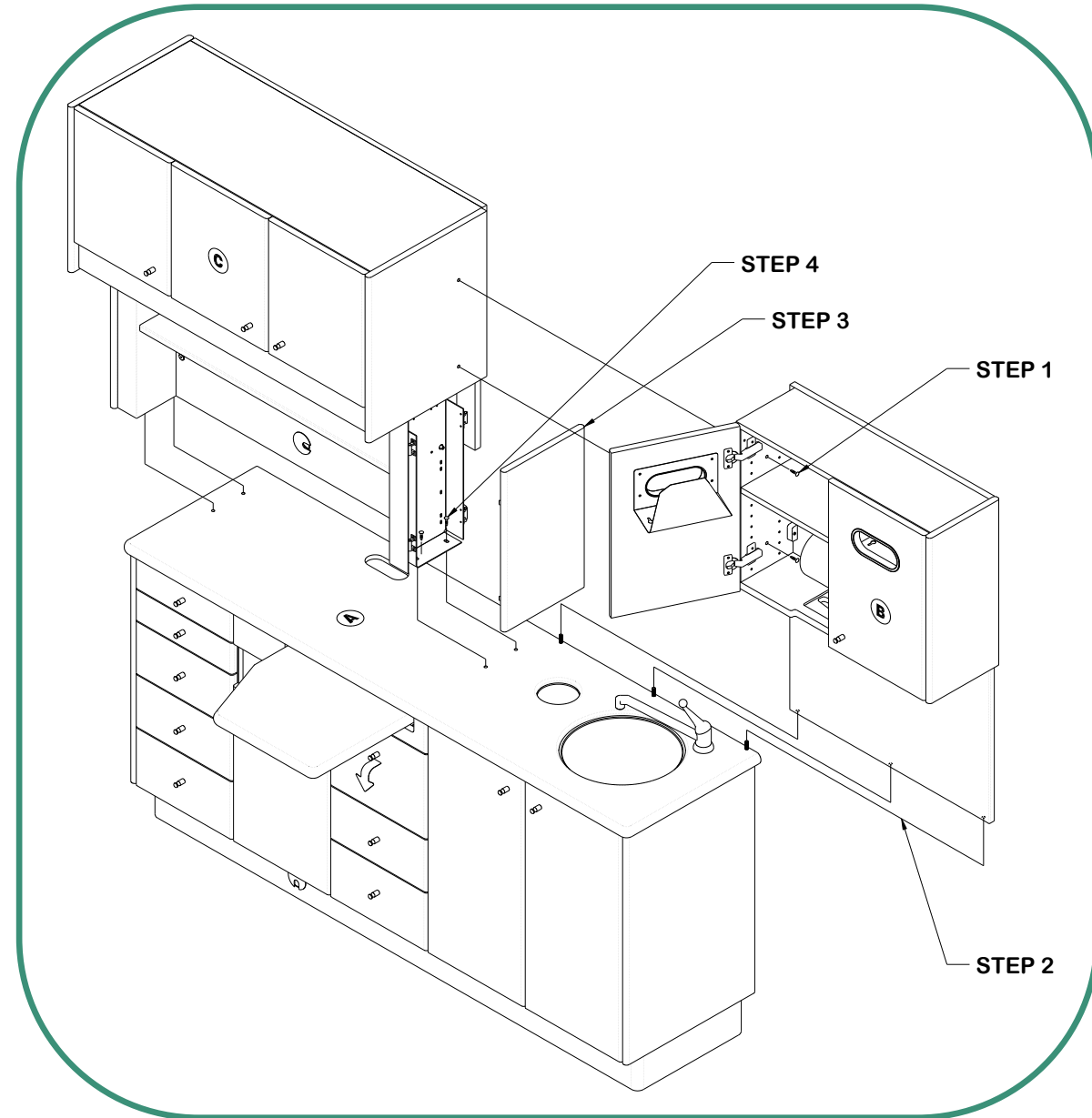

- STEP 1:** Open the glove/cup/towel cabinet door and remove the 2 fastening screws.  
**STEP 2:** Lift the glove/cup/towel assembly "B" off of the countertop "A"  
**STEP 3:** Remove the column front on both sides by pulling outward to reveal the column fasteners.  
**STEP 4:** Remove the 2 fastening screws at each column and lift the upper assembly "C" from the countertop "A"

## ASSEMBLY / DISASSEMBLY

### CENTRE ISLAND

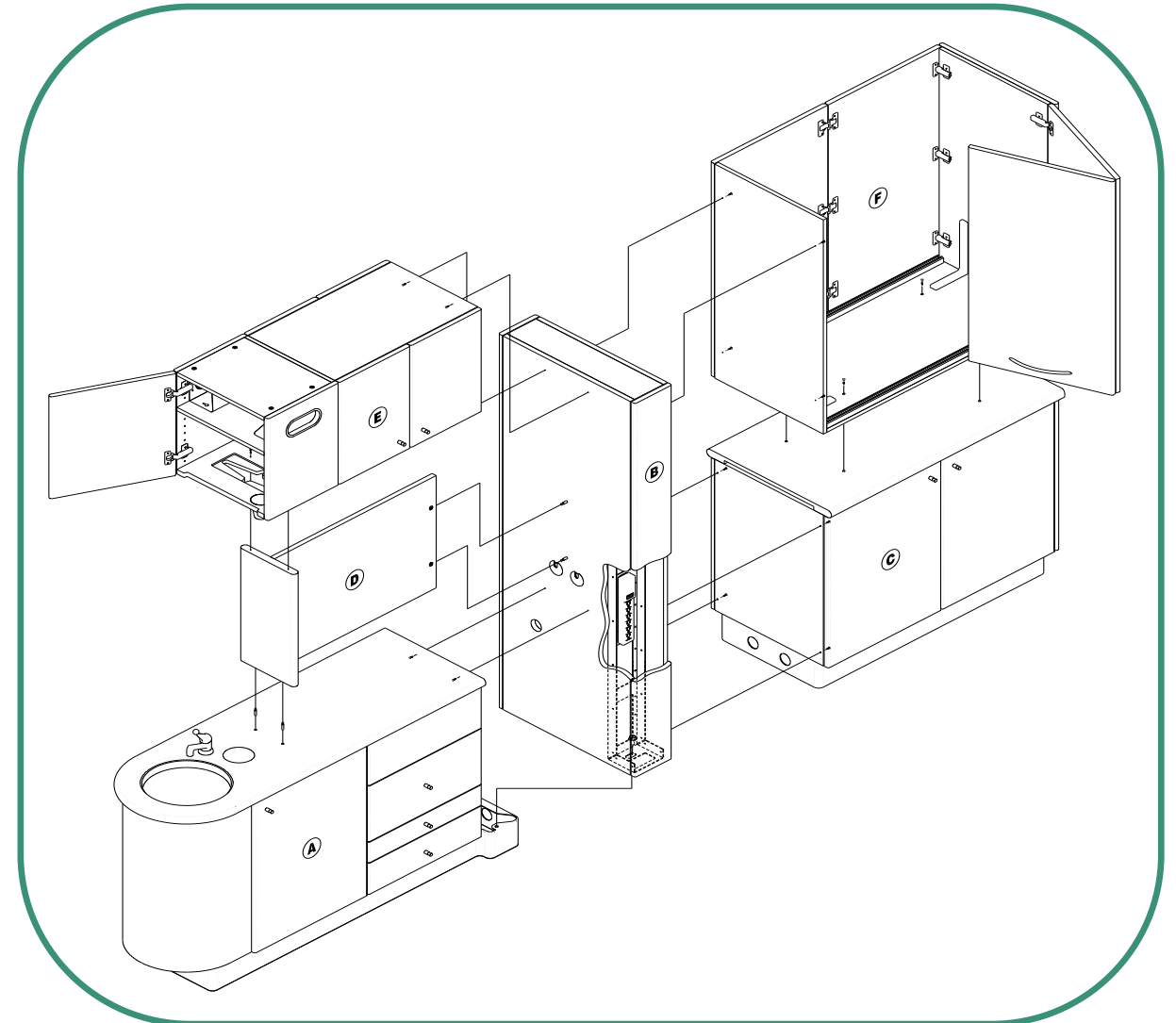

- STEP 1:** Install steel bases to floor as shown on the "Steel Base Installation" instruction page 14.  
**STEP 2:** The support column (B) is bolted to the steel base of subassembly (A) and screwed together.  
**STEP 3:** Subassembly (C) is fastened to support column (B)  
**STEP 4:** Hutch (D) is fastened down to the counter and to support column (B).  
**STEP 5:** Upper subassembly (E) is fastened to support column (B).  
**STEP 6:** The pass through x-ray cabinet (F) is screwed to support column (B) and subassembly (C).



## ASSEMBLY / DISASSEMBLY

Side Cabinet

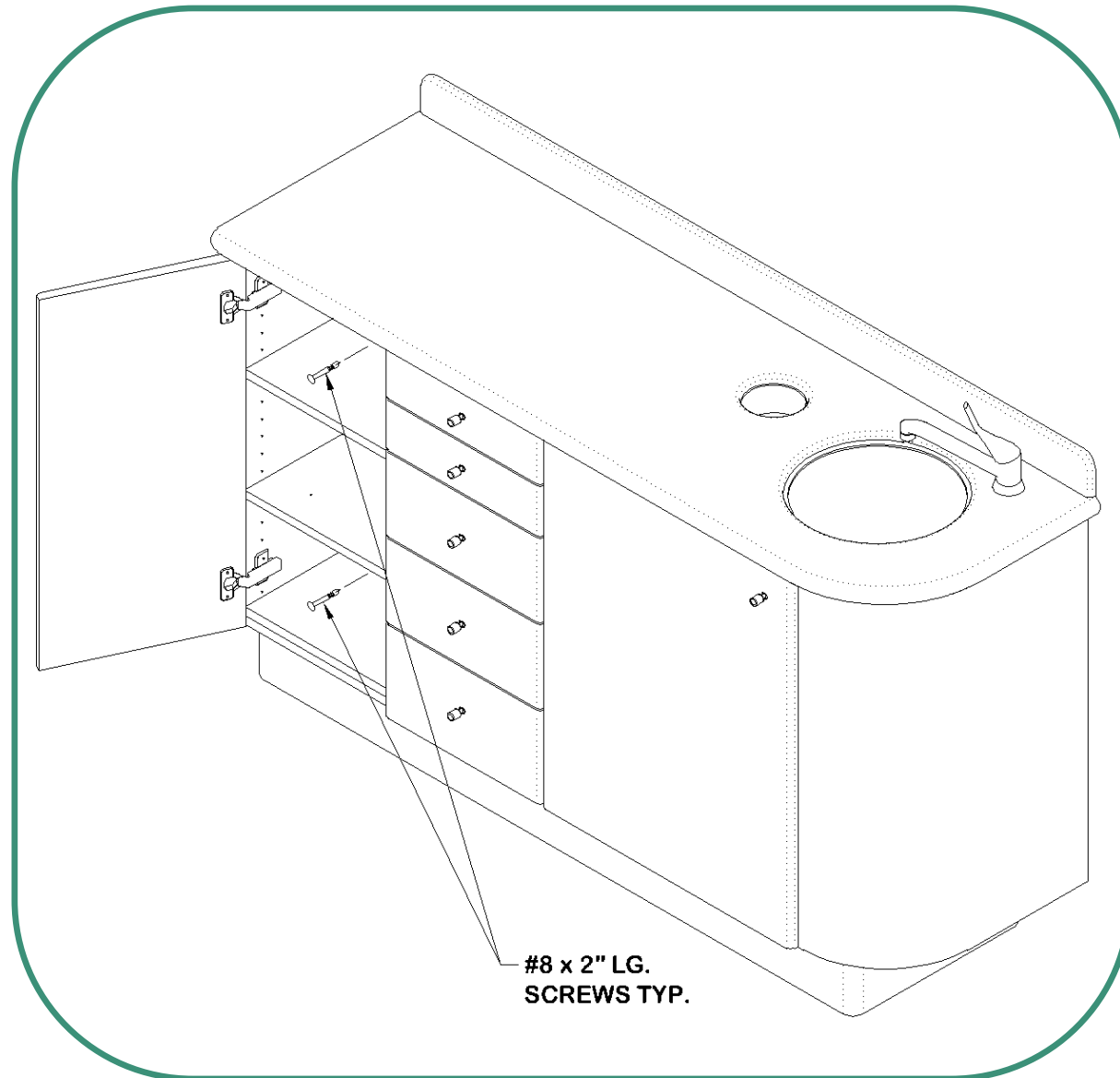

- STEP 1:** Locate and mark wall studs or blocking fastening the unit to the wall.  
**STEP 2:** Level unit to the floor using the four levelers supplied in the kick base.  
**STEP 3:** Fasten the unit to the wall using the supplied fasteners, minimum of 4 should be used.  
**STEP 4:** Attach supplied cover caps to the fasteners heads.  
**STEP 5:** Make final door and drawer adjustments where required.

## ASSEMBLY / DISASSEMBLY

Upper Cabinet

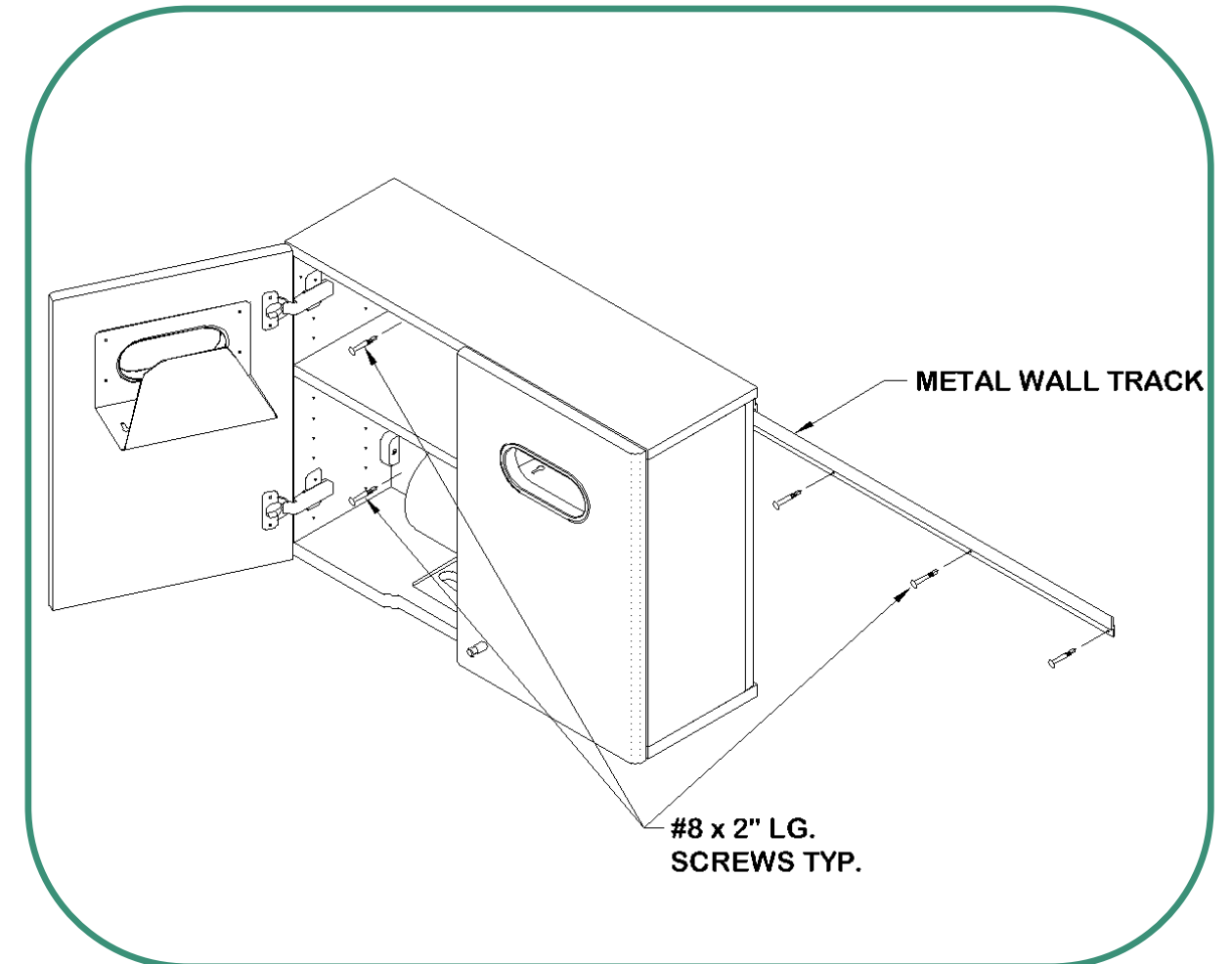

- STEP 1:** Determine location of upper to locate the metal wall track.  
**STEP 2:** Locate and mark wall studs or blocking for fastening the metal wall track to the wall.  
**STEP 3:** Level the metal wall track and fasten it to the wall with the appropriate fasteners. Ensure the track is firmly secured to the studs or blocking at a minimum of 16" spacing.  
**STEP 4:** Hang the upper to the securely installed wall track by mating it to the preinstalled track on the back of the upper.  
**STEP 5:** Fasten the unit thru the cabinet back to the wall at the stud or blocking locations using the appropriate fasteners (minimum of 4 fasteners should be used).  
**STEP 6:** Attach supplied cover caps to fasteners heads.  
**STEP 7:** Make final door adjustments where required.

## ASSEMBLY / DISASSEMBLY

### STERILIZATION CENTRE

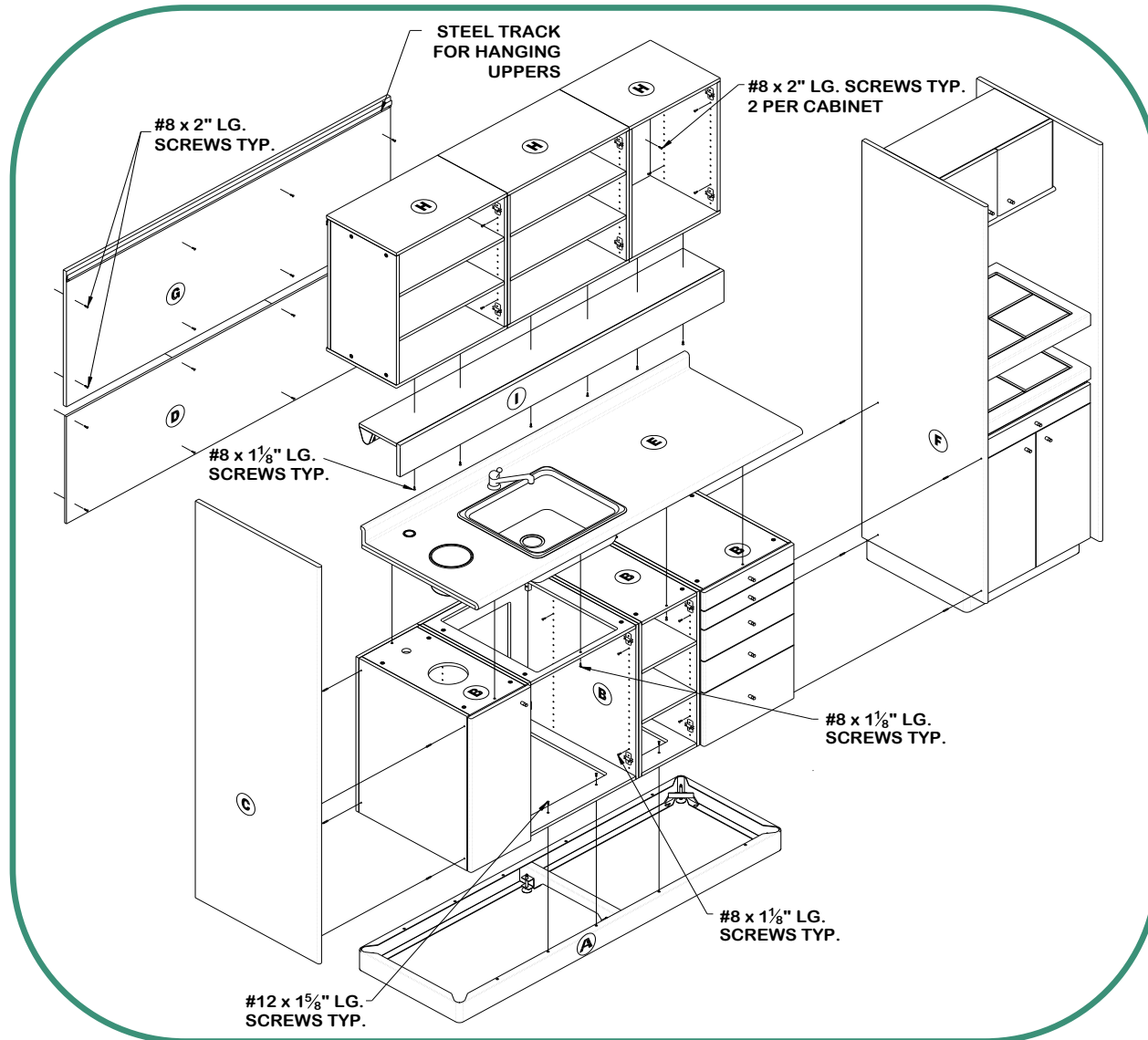

- STEP 1:** Attach all the base cabinets (B) to the steel base (A), and the side panel (C) is attached.
- STEP 2:** Set backsplash (D) on the base cabinets and attach to the wall. Counter (E) goes on base cabinets next.
- STEP 3:** Sterilization tower (F) is screwed to base cabinets and upper cabinet support (G) is set on backsplash and fastened.
- STEP 4:** Upper cabinets (H) are hung on the support panel, and fastened to wall with additional fasteners and side panel. The valance assembly (I) is attached to the upper cabinets (H).

## INSTALLATION

### STEEL BASE

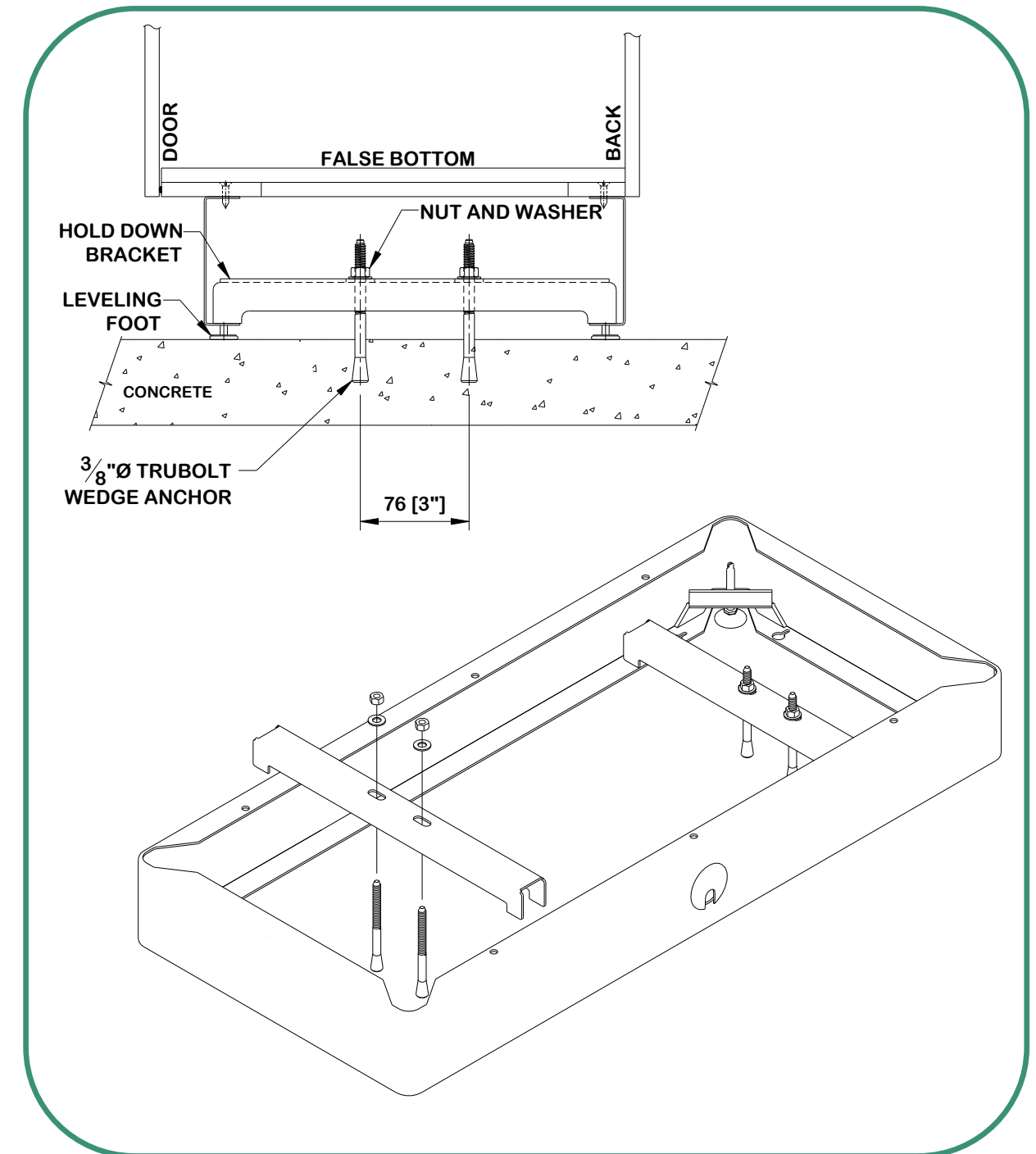

## INSTALLATION

### PASS THROUGH X-RAY

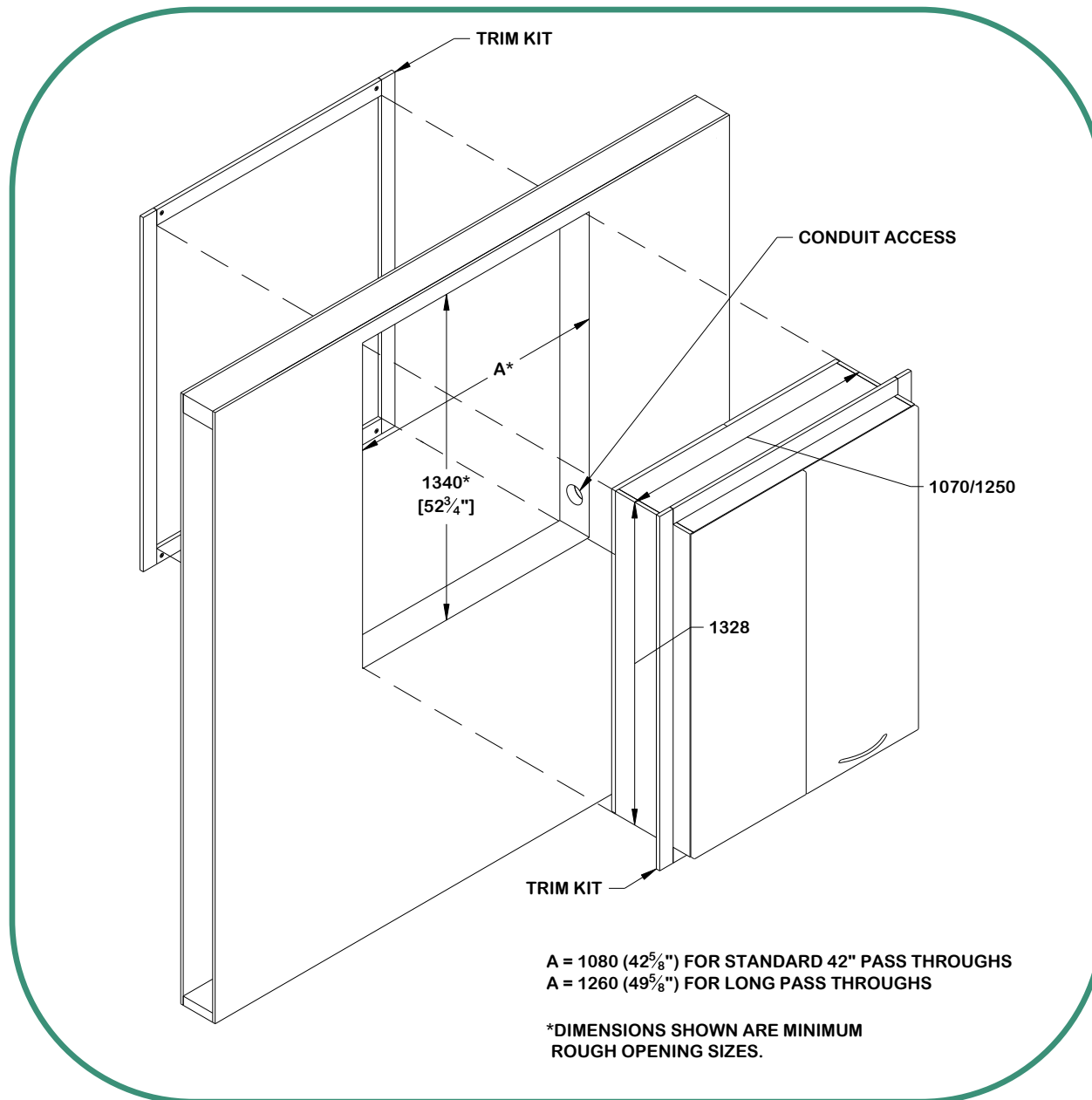





Thank you for trusting us with your project!

We'd love to hear from you on how well we did. Please take a short moment to fill out this survey, or scan the QR code at the bottom of this form to fill it out online.

Client Name:\_\_\_\_\_

Project:\_\_\_\_\_

- How well did we meet your needs?

Not at all

Well

Extremely well

|   |   |   |   |   |   |   |   |   |    |
|---|---|---|---|---|---|---|---|---|----|
| 1 | 2 | 3 | 4 | 5 | 6 | 7 | 8 | 9 | 10 |
|---|---|---|---|---|---|---|---|---|----|

- How would you rate the quality of our product?

- Please select each area you were satisfied with:

☐ Style/Design

☐ Ease of Assembly

☐ Instruction Sheet

☐ Functionality

☐ Finish

☐ Delivery Time

☐ Price/Value

☐ Packaging

☐ Service

- Overall, how satisfied were you with Bow Wood?

Not at all

Well

Extremely well

|   |   |   |   |   |   |   |   |   |    |
|---|---|---|---|---|---|---|---|---|----|
| 1 | 2 | 3 | 4 | 5 | 6 | 7 | 8 | 9 | 10 |
|---|---|---|---|---|---|---|---|---|----|

- If there was one thing we could have done better, what would it have been?

- How likely would you recommend Bow Wood to a friend or colleague?

Not likely

Likely

Very likely

|   |   |   |   |   |   |   |   |   |    |
|---|---|---|---|---|---|---|---|---|----|
| 1 | 2 | 3 | 4 | 5 | 6 | 7 | 8 | 9 | 10 |
|---|---|---|---|---|---|---|---|---|----|

- Consent

☐ Yes, I would like to subscribe to Bow Wood Dental Cabinets e-Newsletter

E-mail address: \_\_\_\_\_

Please fax your response back to (306) 483-2102 — Thank You!

For Questions or concerns please call:  
Bow Wood Cabinet Systems 1.888.BOW.WOOD(269.9663)

